



Flex-Mix In-line Mixer type DAR

Application

The in-line mixer type DAR is designed for continuous mixing of different liquid combinations, mixing of high viscosity products and other substances and in-line emulsification. It is especially suitable for mixing of butter and similar products where a homogeneous, liquid free and blended product is required.

Capacity

Up to 6,000 kg/h.

Operation

The mixer is an inline, multistage rotor/stator mixer.

A number of stator rings with holes are placed in a cylinder pipe. The rotor wheels are placed between the stator rings. The rotor wheels comprise a number of pins, which rotate with the shaft. The products are led axially through the holes in the stator rings and at the same time the rotors create a tangential shear by which the products are blended / mixed.

The mixer does not generate any pumping effect and thus a feed pump is required to ensure the liquid flow through the mixer.

Standard specification

- All parts in contact with the product are made of stainless steel AISI 316L / DIN1.4404.
- Closed coupled design
- Motor is totally enclosed according to IEC or NEMA norm, covered by a stainless steel shroud.
- Double mechanical, flushed shaft seal made of SiC/Carbon alternatively of SiC/SiC seal ring material (W+ pump seal)
- Seal material of EPDM or FPM (Viton), FDA quality
- Sanitary design and 3A execution for CIP cleaning
- Two basic mixer sizes: 3" and 4" rotors (DAR 75 and DAR 100)
- In/outlet dimensions: 1½", 2½", 3", and 4" or NV40, 65, 80, and 100.
- In/outlet fittings in accordance with required standard, ISO, DIN, etc.
- Delivered with or without console (support)

Technical data

| | | DAR 75 | DAR 100 |
|------------------------------|------------|--------|---------------|
| Motor | kW | 3-4 | 3-4 / 5,5-7,5 |
| | rpm @ 50Hz | 1450 | 1450 |
| Liquid capacity, max. | kg/h | 3000 | 6000 |
| Max. temperature | C° | 140 | 140 |
| System pressure, max. | bar | 25 | 25 |
| Service water for shaft seal | | | |
| Consumption | l/h | 15-30 | 15-30 |
| Pressure, max. | bar | 7 | 7 |
| Number of rotors | | 4 | 4 |
| Number of stators | | 3 | 3 |

Dimensional sketches

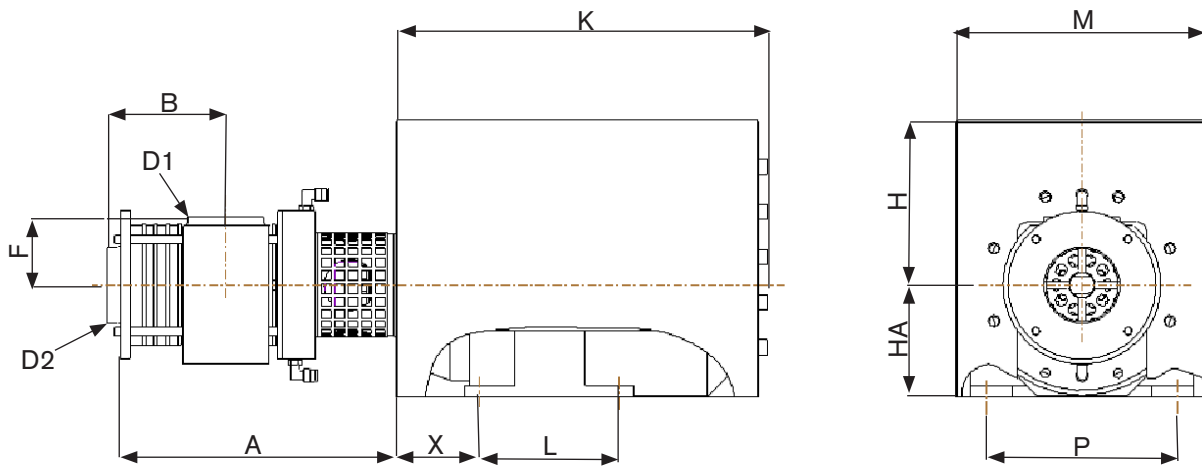

| Type | Dim. (mm) | | | | | Motor size (IEC) | | Weight (kg) (incl. motor) | |
|-----------------|-----------|-------|------|-----|-----|------------------|-----|---------------------------|-----|
| | D1* | D2* | F | B | A | 112 | 132 | 112 | 132 |
| DAR 75-38/38 | 38 | 38 | 58 | 115 | 274 | x | | 51 | |
| DAR 100-63/63 | 63,5 | 63,5 | 68,5 | 117 | 289 | x | | 57 | |
| DAR 100-76/76 | 76,6 | 76,6 | 68,5 | 124 | 308 | x | x | 62 | 87 |
| DAR 100+101/101 | 101,6 | 101,6 | 68,5 | 130 | 337 | x | x | 69 | 94 |
| | | | | | | | | | |
| | | | | | | | | | |

| Dim. (mm) | Motor size (IEC) | |
|-----------|------------------|-----|
| | 112 | 132 |
| HA | 112 | 132 |
| X | 70 | 89 |
| L | 140 | 178 |
| H | 163 | 185 |
| K | 371 | 446 |
| M | 253 | 293 |
| P | 190 | 216 |

*: OD

Note: The dimensions are without fittings.

APV, An SPX Brand, Pastervej 1, 8600 Silkeborg, Denmark
Phone: +45 70 278 278 Fax: +45 70 278 330

For more information about our worldwide locations, approvals, certifications, and local representatives, please visit www.apv.com.

SPX Corporation reserves the right to incorporate our latest design and material changes without notice or obligation. Design features, materials of construction and dimensional data, as described in this bulletin, are provided for your information only and should not be relied upon unless confirmed in writing.

Issued: 07/2009 6205-02-07-2009-GB

Copyright © 2008, 2009 SPX Corporation

SPX[®]
WHERE IDEAS MEET INDUSTRY